

Quick Start Guide

Bolt Down Kit

meetpat Portable Accessories PT-BK-01

The meetpat Bolt Down Kit is compatible with the Portable Bottle Refill Station PT-RS-03.

This accessory consists of two easy to fit ramps, providing additional stability to the portable refill station. With a non-slip top surface, they are ideal for turning the portable system into a more robust solution.

IB-010-000-00

WELCOME

We began meetpat to change the way people think about public water stations, and in doing so we believe we can drive change for generations to come.

Fundamentally, we care about delivering safe, clean water and ensuring positive public adoption of water stations.

meetpat water stations are world class and intuitive however, use or misuse of this product can not always be predicted. So, as we hand over this product to you, our customer, it will commence adoption into your community or business and become a relied upon resource. We therefore, encourage you to undertake regular servicing and maintenance. This will keep the product functioning at it's absolute best and ensure the positive public adoption of your water station.

Not undertaking regular servicing and maintenance will result in poor user engagement and is likely to effect the product warranty.

Congratulations on purchasing a world class, smart water station.

Please follow the meetpat Refill Station Information Booklet to effectively install your product. Information Booklets are supplied with each Bottle Refill Station or accessible via the link below.



meetpat acknowledge and pay respects to Wiradjuri peoples, Elders and Country whose land we operate our business.

We also acknowledge that Aboriginal and Torres Strait Islander peoples hold extensive knowledge about connections to water, which has been practiced for thousands of generations.

OVERVIEW | SET UP GUIDE

1

SET UP PORTABLE BOTTLE REFILL STATION(S)

Follow Set Up Guide supplied with the refill station Information Booklet.

- Ensure you adhere to the accessibility and safeguards.
- Refill station(s) must be connected and functioning prior to fitting the Ramp Kit.

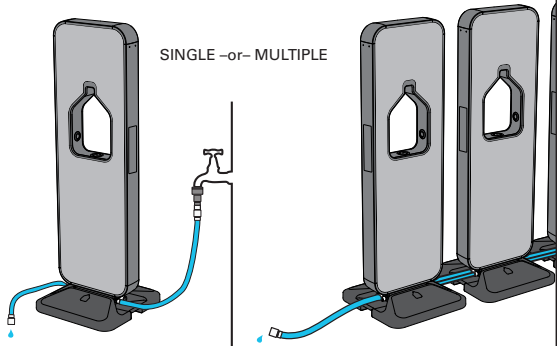

2

Remove and retain 2 x Bolts. Located in the refill station base.

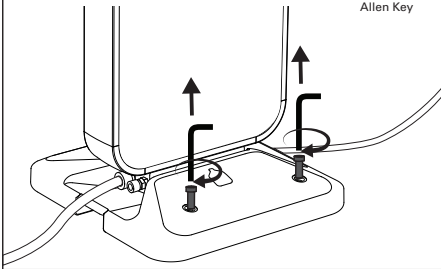

3

Locate a ramp over the refill station base. Aligning the bolt holes.

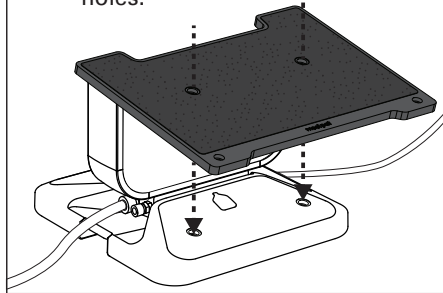

4

Refit 2 x Bolts and hand tighten.

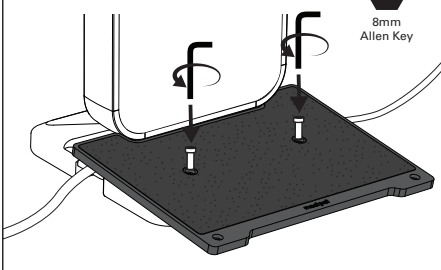

5

Repeat steps to alternate side.

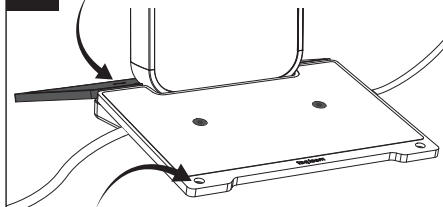

OPTIONAL Extra holes in ramp kit can be used to bolt to another surface for additional anchoring.

» FINISHED REMOVE THE RAMP KIT. FOLLOW STEPS IN REVERSE. STORING BOLTS IN REFILL BASE FOR FUTURE USE.

meetpat®



meetpat products must be installed in accordance with the provisions of AS/NZS3500.1 and AS/NZS3500.2 and any relevant local regulations. Installations not complying with AS/NZS3500.1 and AS/NZS3500.2 may void the product and performance warranty provisions.

meetpat products are Watermarked WMTS105 to Australian standards and have brass free water system parts.

All recommendations within this document should be used as a guide only. Users and installers should seek suitable assistance to ensure units comply with all standards and are safe for use.

meetpat are constantly evolving and updating their products to ensure that they are designed and manufactured to the highest possible standard.

Please ensure you follow the supplied current guidelines when installing and servicing your water station.

For the most up to date copy of this Information Booklet, please visit meetpat.com.au

Meet Pat™ | Meet PAT Pty Ltd | meetpat.com.au

Phone: (02) 6021 0300, +612 6021 0300 Email: sales@meetpat.com.au
